

# FUEL PUMP ASSY (2UZ-FE)

## COMPONENTS

110RH-01

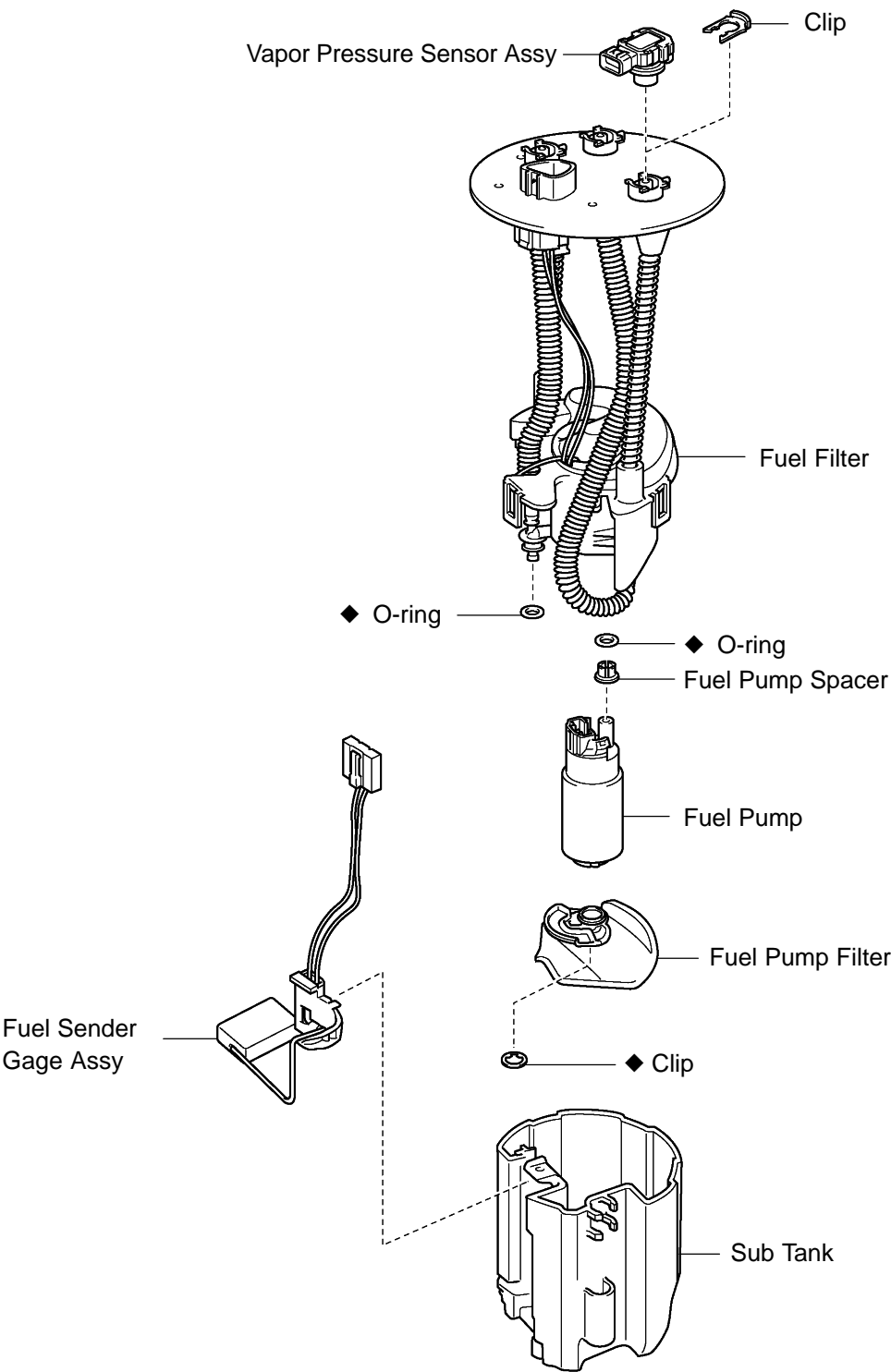

Y ◆ Non-reusable part

A76676

## Removal & Installation and Disassembly & Reassembly

### 1. REMOVE FUEL SUCTION W/PUMP & GAGE TUBE ASSY (See page 11-14 )

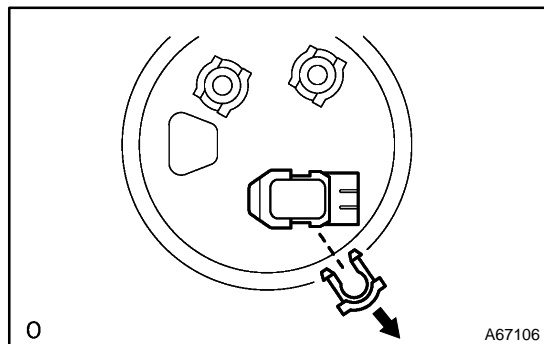

### 2. REMOVE VAPOR PRESSURE SENSOR ASSY

- (a) Remove the tube joint clip, and pull out the vapor pressure sensor.

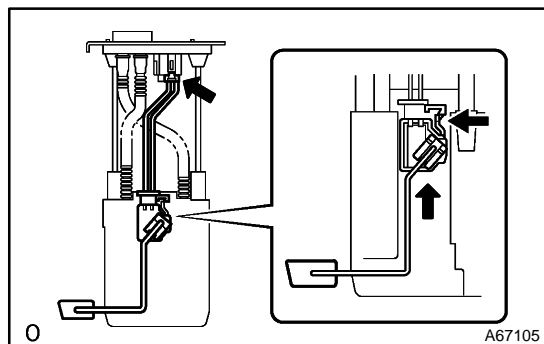

### 3. REMOVE FUEL SENDER GAGE ASSY

- (a) Disconnect the fuel sender gage connector.  
(b) Unlock the fuel sender gage, and slide it to remove.

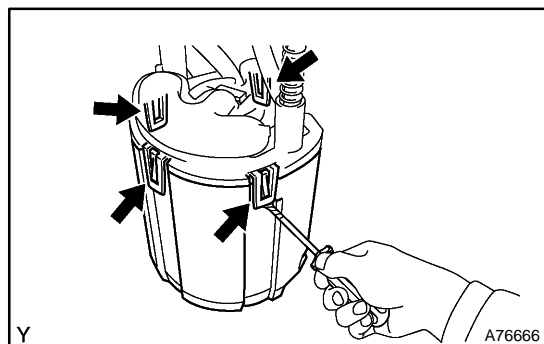

### 4. REMOVE FUEL PUMP ASSY W/FILTER

- (a) Using a screwdriver, disconnect the 4 snap-claws from the claw holes and remove the sub tank.

#### NOTICE:

**Do not damage the sub tank.**

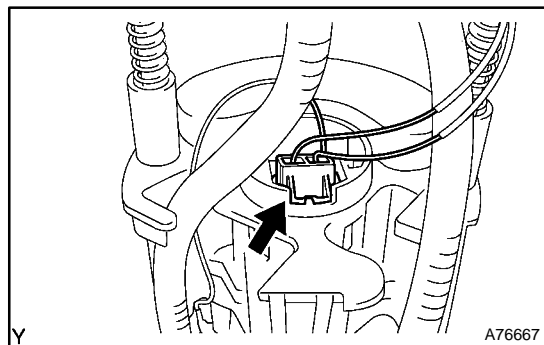

- (b) Disconnect the fuel pump connector.

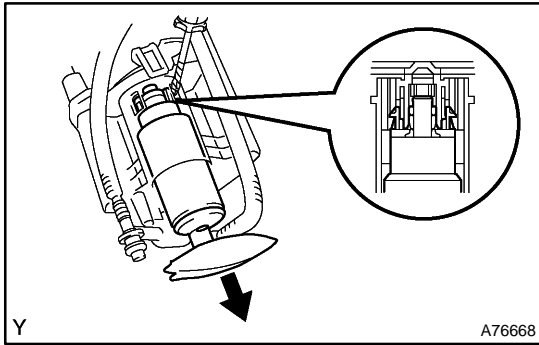

- (c) Using a small screwdriver, disconnect the 2 claws from the claw holes and remove the fuel pump w/ filter.
- (d) Remove the fuel pump O-ring from the fuel pump.
- (e) Remove the fuel pump spacer from the fuel pump.

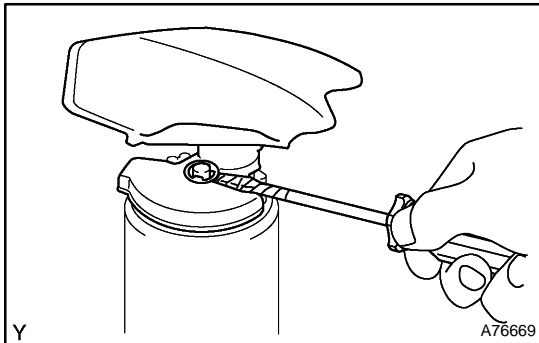

#### 5. REMOVE FUEL PUMP FILTER

- (a) Using a small screwdriver with tip wrapped in tape, pry out the clip.
- (b) Pull out the fuel pump filter from the fuel pump.

#### 6. INSTALL FUEL PUMP FILTER

- (a) Install the fuel pump filter with a new clip.

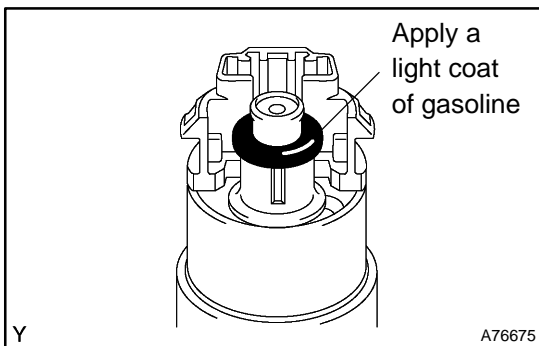

#### 7. INSTALL FUEL PUMP ASSY W/FILTER

- (a) Install a fuel pump spacer to the fuel pump.
- (b) Apply a light coat of gasoline to a new O-ring and install it to the fuel pump.
- (c) Apply a light coat of gasoline to the O-ring again, and install the fuel pump to the fuel filter.

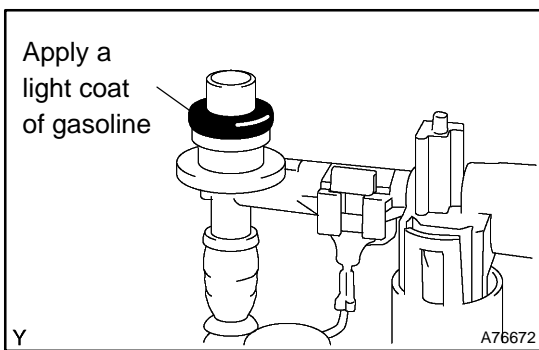

- (d) Install the sub tank.
  - (1) Apply a light coat of gasoline to a new O-ring and install it to the fuel suction tube assy.
  - (2) Apply a light coat of gasoline to the O-ring again, and install the sub tank to the fuel filter.

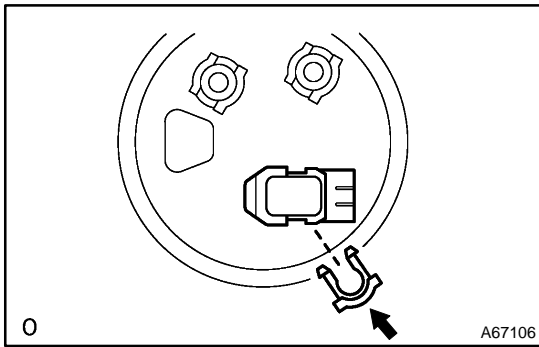
**8. INSTALL VAPOR PRESSURE SENSOR ASSY**

(a) Install the vapor pressure sensor with the tube joint clip.

**NOTICE:**

- Check that there is no scratch or foreign objects on the connecting parts.
- Check that the fuel tube joint connector is fully inserted.
- Check that the tube joint clip is on the collar of the fuel tube joint.
- After installing the tube joint clip, check if the fuel tube joint connector is securely connected by pulling it.

**9. INSTALL FUEL SUCTION W/PUMP & GAGE TUBE ASSY (See page 11-14 )**